



Lockside House, Chelsea Creek
London SW6

GARTON JONES.COM



Lockside House, Chelsea Creek London, SW6

GARTON JONES.COM

11 Park Street
Chelsea Creek
London
SW6 2FS

Sales +44 (0) 20 7824 7090
paul@gartonjones.com
www.gartonjones.com

£750,000 Leasehold

A well-presented one-bedroom apartment offered to the market with Parking and including high quality furniture offering accommodation 585 sq.ft (55sq.m) whilst located in Lockside House, Chelsea Creek development. The apartment has an open plan reception room with access to a private balcony. There is an open plan kitchen with integrated appliances, double bedroom, and bathroom. Residents also benefits from access to the Spa and fitness suite with Swimming pool as well as a 24-hour Concierge. King's Road and Chelsea Harbour are easily accessible. Chelsea Creek is located nearby to Imperial Wharf Overground station and half a mile away you will find Fulham Broadway Underground station which offers District line services both offering excellent links around London as well as the famous Kings Road which offers a wide range of designer boutiques, top class restaurants, bars and quaint cafes.

Service Charge - £4000PA
Ground Rent - £350PA
Lease 999 from 1st June 2010

Council Tax — London Borough Of Hammersmith & Fulham Council - Band E

EPC — B (83)

EPC certificate available on request.

- One Bedroom
- Parking & Furniture Included
- 585 Sq.ft (55 Sq.m)
- Private Balcony
- Modern Décor
- Open Plan Living
- Integrated Appliances
- 24 Hour Concierge
- Access To The Residents Gym & Spa
- EPC - B (83)



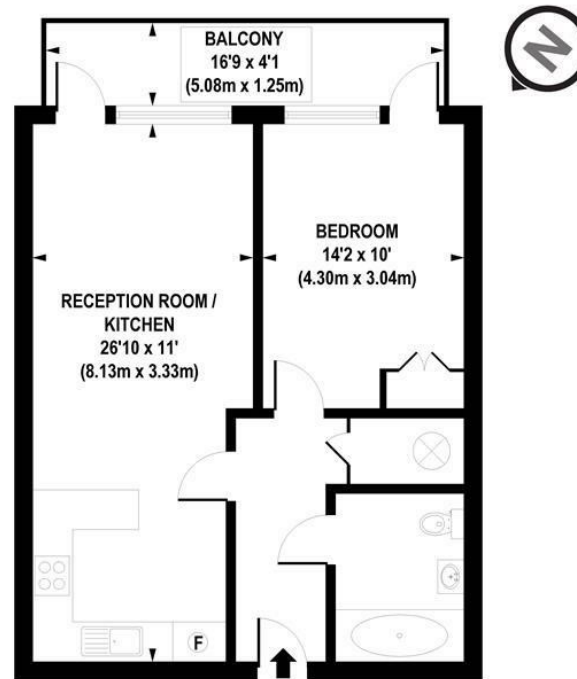

APPROX. GROSS INTERNAL FLOOR AREA 571 sq. ft / 53.01 sq. m

Floorplan is for illustrative purposes only and is not to scale.
Every attempt has been made to ensure the accuracy of the floorplan shown, however all measurements, fixtures, fittings and data shown are an approximate interpretation for illustrative purposes only.
Liability for errors, omissions or mis-statement through negligence or otherwise is hereby excluded.

CP CREATIVE
PROPERTY MARKETING

